





**GB OPTICAL SMOKE ALARM DEVICE PEBBLE 10Y**

Congratulations on the purchase of your new smoke alarm device. We recommend that you spend some time reading this instruction manual in order to fully understand all the operational features. You will also find some hints and advice to help you resolve any issues. Read all the safety instructions carefully before use and keep for future reference.

The Housegard smoke alarm device is designed to detect smoke particles and to reduce the number of false alarms and to give an early warning if a fire occurs, but it's operation depends on correct positioning and maintenance.

**FEATURES**

- Early warning
• High sensitivity and stability
• Test/Pause button
• LED diode indicates normal operation
• Low voltage warning
• Sealed in for life battery 10Y
• Local smoke alarm memory

**TECHNICAL SPECIFICATIONS**

Table with 2 columns: Specification (Model No, Detection type, Power source, Standby current, Alarm current, Alarm sound level, Operating temperature, Ambient humidity) and Value (SA701, Photo electric, 3V lithium, <2 uA, <120 mA, 85 dB /3 m, -10 °C - +40 °C, 95% RH).

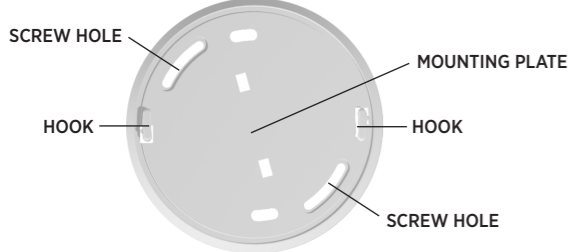
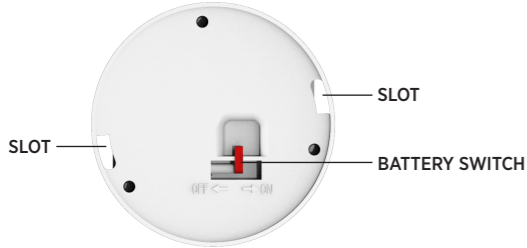
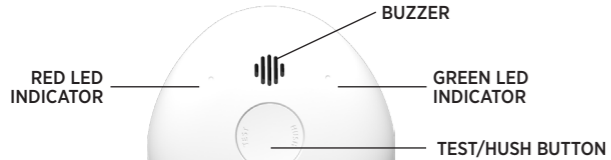

**IMPORTANT SAFETY INFORMATION**

1. The smoke alarm device is battery-powered. The smoke alarm device will not work without batteries, or if the batteries are dead, removed or not correctly connected. Only use the specified type of battery. DO NOT connect the smoke alarm device to any type of detector or equipment other than what is stated in this manual.
2. The test button provides a full test of all the smoke alarm device's functions. No other test methods are required. Test smoke alarm devices every week to check that they are working properly.
3. Do not remove or disconnect the batteries to stop false alarms, as this will cause the smoke alarm device to lose important functionality. Open a window or ventilate the air around the smoke alarm device to stop the alarm and/or press the pause button.
4. The smoke alarm device must be installed in line with all local and national rules and regulations on installation.
5. The smoke alarm device is intended for use in houses. In apartment blocks, each apartment should be fitted with its own smoke alarm device. This smoke alarm device is not suitable for use in non-residential buildings. The smoke alarm device is not a replacement for a complete alarm system as required under law or by the fire safety authorities.
6. There may be reasons why a person in a household might not hear the alarm (e.g. noise, deep sleep, impaired hearing). If you suspect that a person in the household will not hear the smoke alarm device, specialist alarms should be installed. If a person in the household has impaired hearing, special alarms should be installed to alert the person via sound, light and vibrations.
7. The smoke alarm device detects combustion particles in the air (smoke). It does not react to flames or gas. The smoke alarm device is designed to give off an audible alarm if a fire is developing.
8. No smoke alarm devices are entirely reliable and they cannot give a 100% guarantee to protect life and property against fire. The smoke alarm device is no replacement for insurance. Homeowners and tenants should take out life and home insurance.
9. The smoke alarm device should be tested regularly and replaced every ten years.

Note: For maximum security, install one smoke alarm device in each and every room.

**POSITIONING THE SMOKE ALARM DEVICE**

For the smoke alarm device to give an early warning, it needs to be installed where the fire occurs. Housegard therefore recommends that you install a smoke alarm device in every room and on all floors.

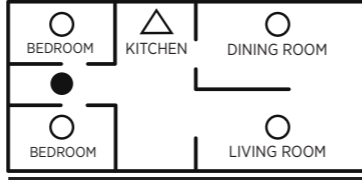

Single-story residence, apartment, Mobile home

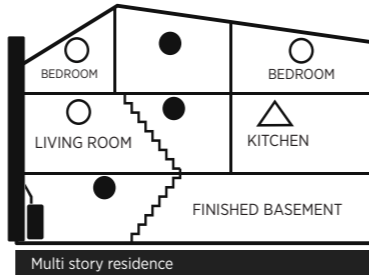

Multi story residence

- KEY:
● Minimal protection
○ Recommended/more substantial protection
△ Smoke alarm devices with a pause function are recommended

**Correct placement of the smoke alarm device**

- Install a smoke alarm device in all separate bedrooms and in rooms commonly occupied.
• In homes with several storeys, a smoke alarm device should be installed at the top of every staircase between each storey.
• In the basement, a smoke alarm device should be installed on the ceiling at the foot of the stairs.
• In bedrooms where people sleep with closed doors, there should always be a smoke alarm device fitted in the bedroom.
• Install a smoke alarm device in every room where there is a potential risk of fire.
• Install a smoke alarm device at each end of corridors, if they are longer than 9 metres.
• Install the smoke alarm device in the middle of the ceiling. If this is not possible, install the smoke alarm device on the wall at least 0.5 m from any corner and at least 10–15 cm from the ceiling. (Wall-mounting is not recommended).

**SMOKE ALARM DEVICES SHOULD NOT BE PLACED IN THE FOLLOWING LOCATIONS**

1. In the kitchen, near the cooker, where smoke from cooking could cause false alarms.
2. In areas of high air humidity, such as bathrooms or near dishwashers or washing machines, where steam and moisture could cause false alarms.
3. Near fans and ventilation ducts, where air flows may prevent smoke from reaching the smoke alarm device.
4. Near light sources and electrical equipment that emit an electromagnetic field.
5. Near a fireplace or stove with an open fire.
6. At the top of a V-shaped ceiling, where air pockets could stop the smoke from reaching the smoke alarm.
7. In a garage, where exhaust fumes could cause false alarms.
8. In dusty and dirty areas, where the dust and dirt could damage the smoke alarm device.
In rooms where the temperature may fall below -10°C or rise above +40°C, or in rooms with large temperature variations.

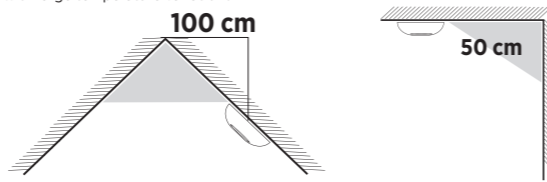

WARNING: Incorrect positioning may lead to reduced reliability and false alarms.

**PROTECT YOUR HEARING**

Smoke alarm devices emit a loud audible signal. We recommend that you always use earplugs or other hearing protection when testing your smoke alarm devices.

Holes ceiling/wall 5 mm

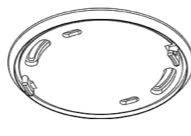

Two screws

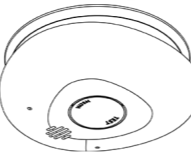

**HOW TO INSTALL YOUR SMOKE ALARM ALARM**

WARNING: Installation of the smoke detector must be carried out in accordance with the instructions, all national laws, regulations and other local rules that may apply.

1. Remove the mounting plate on the back of the smoke alarm by twisting it counter clockwise.
2. To activate the smoke alarm pull out the battery switch and lock it in the mid position.
3. Install the mounting plate in the chosen position on the ceiling. Take care to position your smoke alarm device properly.
4. Place the smoke alarm device against the mounting plate and twist the smoke alarm device clockwise until it clicks into place.
5. Press and hold the test button for at least 1 second to test the smoke alarm.

**EASY INSTALLATION WITH TWO-SIDED ADHESIVE TAPE**

Make sure that the installation surface is flat and clean. If the surface is rough, we recommend that you install the smoke alarm with the help of the screws.

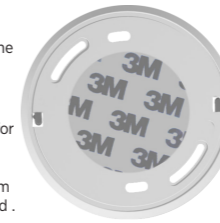

1. Remove one side of the 3M tape protection.
2. Attach the tape on the base plate on back of the smoke alarm. Press for 5 seconds.
3. Remove the second side of the 3M tape protection.
4. Place the smoke alarm according to the manual. Press the smoke alarm for five seconds against the ceiling to make sure that it is well attached.
5. Press and hold the test button for at least 1 second to test the smoke alarm.

**OPERATION**

During normal operation, the smoke alarm device's LED flashes every 344 seconds. This means that the battery and the unit are working correctly. If the alarm detects smoke, it will emit pulsating warning signals and the red LED will flash.

FOR YOUR SAFETY! NEVER IGNORE A SMOKE ALARM DEVICE THAT HAS GONE OFF. WHEN YOU HEAR THE ALARM SIGNAL, YOU MUST GIVE IT YOUR FULL ATTENTION AND ACT ACCORDINGLY.

**Normal Mode**

In standby condition the indicator flashes every 344 seconds to indicate that the smoke alarm is operating properly. The smoke alarm detects smoke every 10 seconds. When it senses smoke, the alarm sounds and the indicator flashes red at the same time, until the air is clear.

**Pause mode (Low sensitivity)**

The smoke alarm is desensitized by pushing the TEST/HUSH button. The alarm indicator flashes every 9 minutes and no audible sound will be heard during 9 minutes, unless smoke becomes denser. If the smoke becomes denser, the alarm will override the pause mode. The pause mode will end automatically after 9 minutes or by pressing the TEST/HUSH button again.

**Low battery warning**

The low battery warning will indicate when the voltage is too low, the smoke alarm will then make short beeps every 43 seconds.

**Test mode**

By pressing the TEST button the smoke alarm will enter alarm mode. The unit will make beeps every 0,5 second and the indicator will flash red.

**Alarm Memory**

This smoke alarm is equipped with an alarm memory, which provides a visual indication when an alarm has been activated. When the indicator flashes green 3 times every 43 seconds, that means alarm has been made during the last 24 hours. Check if there is fire risk in detection area. This indication will end after 24 hours or when pushing Test/Hush button. First time you press TEST/HUSH button after alarm is made, the smoke alarm will indicate by special alarm mode.

**End of life mode**

The time and working environment will cause the degeneration of smoke chamber. When the product makes 3 short beeps every 43 seconds, it indicates end-of-unit-life. You should replace the smoke alarm with a new one.

**MEANING OF THE DIFFERENT LED AND ALARM SIGNALS**

Table with 5 columns: STATUS, RED LED, GREEN LED, ALARM SIGNAL, DESCRIPTION. Rows include Normal mode, Pause mode, Low battery, Alarm/test mode, Alarm memory, and End of life.

**TESTING THE SMOKE ALARM DEVICE**

The smoke alarm is tested by pressing and holding the test button. The smoke alarm responds by sounding the alarm. The alarm signal stops when you release the test button. Never use an open flame to test the smoke alarm device, it can destroy the smoke alarm device.

1. Always test all devices after installation to ensure that they are functioning properly.
2. The test button performs a full test of all functions. Press and hold the test button for at least 1 second to test the smoke alarm.
3. Test your smoke alarm device routinely once a week.
4. Always test your smoke alarm device after a long period of absence from home.
5. Always stand at arm's length when testing your smoke alarm device to avoid damage to your hearing.

**CAUSES AND REMEDIES FOR FALSE ALARMS**

A smoke alarm device detects and reacts to smoke particles in the air. The smoke particles set off the smoke alarm device. This function means that the smoke alarm device will also react to dust particles, moisture or other particles in the form of pollen, insects and so on. These factors are usually the cause of a false alarm.

Table with 2 columns: CAUSE OF ERROR, ACTION. Rows include Steam and moisture, Dust and dirt, Draughts, dust and air flows, Temperature variations, and Generally unfavourable positions.

**TROUBLESHOOTING**

Warning: Do not remove the battery to end an unwanted alarm.

Table with 2 columns: PROBLEM, ACTION. Rows include no signal when tested, flashing once (red LED), goes off when not smoking, and buzzer beeping 3 times.

**TYPE OF BATTERY**

Voltage: DC 3V
Type: CR123A (Sealed in for life)
Battery life: Approx. 120 months

WARNING: This smoke alarm device is equipped with a sealed in battery. Do not remove the battery from the smoke alarm device to end an unwanted alarm.

**CLEANING AND MAINTENANCE**

The smoke alarm device should be cleaned regularly. Clean your smoke alarm device by vacuuming externally along the opening to the detection chamber to remove dust and dirt.

IMPORTANT: Do not try to open the cover to clean inside the smoke alarm device. This will negate the warranty.

**WARRANTY**

This smoke alarm device comes with a 5-year limited warranty against manufacturing defects. (valid from date of purchase.) The batteries are not covered by the warranty. Liability under the warranty is limited to the value of an equivalent smoke alarm device. Defective smoke alarm devices should be returned to the retailer, along with a description of the problem. If the claim is approved, the faulty goods will be replaced with a new smoke alarm device of the same or an equivalent type. Any claim must be accompanied by a receipt confirming the date of purchase.

**DISPOSAL**

In accordance with the WEEE Directive 2012/19/EU, waste electrical products should not be disposed of with regular household waste. The battery should be removed before disposal of the smoke alarm and both should be disposed of in line with local regulations.

WARNING: Do not open the alarm. Do not burn.

**EC DECLARATION OF CONFORMITY**

Sunmatic The Safety Company AB
Argogatan 2B
SE-43153 Mölndal

Hereby declare under our sole responsibility that the product:
Housegard model smoke alarm SA701
To which this declaration relates is in conformity with the following standards and/or other normative documents:
EN 14604:2005/AC:2008

Technical file held by: Sunmatic The Safety Company AB

Mölnal 2020-02-17

Frank Willy Ottesen

Technical Manager



2831-CPR-F2759
Sunmatic The Safety Company AB
DOP: 601143-CPR-0919
EN 14604:2005+AC:2008